



CPL 155 Combination Padlock Instructions

Set Your Own Combination

1. Set dials to the existing 4-digit combination (factory pre-set to **0-0-0-0**) and open. **(Fig. 1)**
2. With the shackle in the open position rotate the slot at the bottom of the padlock 90° clockwise so that it is perpendicular to the part line **(Fig. 2)**
3. Set your own secret combination, memorise and record it.
4. Rotate the slot back to it's original position, **(Fig. 3)** your new combination is now set.

To Lock: Close the shackle and scramble the dials.

Fig. 1

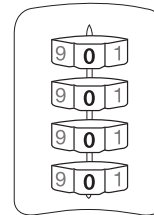

Fig. 2

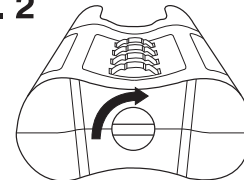

Fig. 3

